



Hello Coaches,

Thank you very much for supporting our 2017 **MCCALL MOUNTAIN MADNESS SOFTBALL TOURNAMENT**. First and foremost, this a fundraising event to support the McCall-Donnelly High School and McCall Mountain Madness Summer Softball Programs. This tournament is our primary fundraising event used to support player development, Team gear, travel and player scholarships for our young women of McCall and Valley County.

This tournament started in 2007 with 8 “B” level teams. Since then, primarily due to the location and quality of the tournament, we have grown to 24+ very high caliber, ASA teams, three playing fields and fill up in early spring. It is our desire to make this your Team’s, coaches and parents favorite event of your summer tournament schedule, and we really do enjoy hosting you.

Some things to pass along for your information and to share with your kids and parents:

1. **This is a fundraiser**, your registration fees go almost entirely to putting on and paying for the Tournament. We know you travel a lot, but we really appreciate your business at our concession and apparel sales!
2. We take a lot of pride in your satisfaction, which we feel comes from the caliber of the teams playing, the conditions of our fields and the quality of our umpires. Please share your positive and constructive feedback on these factors with your Tournament Director(s).
3. We have scheduled games, brackets and locations with a lot of thought to your Team’s travel and convenience. Neither the brackets nor the schedule are perfect, but we appreciate your understanding that **50+** games in three days on three fields is a challenging puzzle to get perfect.
4. We have a very tight schedule. We appreciate Teams being at the field, **warmed up and ready to play 15 minutes before your game** time in case we are able make up a bit of time.

Thank you again for your continued support. We enjoy hosting you and your families in McCall and look forward to this weekend all year long!

Sincerely,

Anthony Botello and Jeff Walker

Tournament Directors



McCall Mountain Madness 2017 Tournament Team Check In Info

Team Name: _____

Head Coach: _____ Phone: _____ ASA # _____

Assistant Coach: _____ Phone: _____ ASA # _____

Assistant Coach: _____ Phone: _____ ASA # _____

Team Manager: _____ Phone: _____ ASA # _____

Welcome Packet

Tournament Rules

Coach, Player, Parent Expectations

Maps to Fields

I have submitted my final roster and any pick up players, and will not be adjusted, and have received and understand Tournament information.

Head Coach (Name Printed)

Signature

Tournament Director (Name Printed)

Signature

Tournament Rules

- 1 Team Rosters and pick up player forms will be submitted on Friday of the Tournament, **to the Tournament Director before your first game and become official.** Failure to submit your roster could result in a game forfeit
- 2 Maximum of two (2) pick up players allowed per team
- 3 NO player is allowed to play on more than 1 (one) team in the Tournament
- 4 16/18u teams will have no more than four (4) 18u players, and 18u players cannot pitch.
- 5 ASA lineup rules apply. Teams will not bat their entire line up
- 6 Teams will have a 3 game guarantee scheduled
- 7 No Pool Play or Seeding - tournament brackets will begin on Team's first game
Be at the field at least 30 min early to warm up. Tournament Director or umpire will start games up to 15 min early if schedule allows.
- 8
- 9 **No new inning at 1:20 and DROP DEAD at 1:30 ON FRIDAY ONLY – Saturday/Sunday no drop dead**
- 10 No Game will end in a tie. USA Softball Tie Breaker Rule will be used. The player scheduled to bat last in the inning will be placed at 2nd.
- 10a IF A GAME IS TIED AT DROP DEAD TIME ON FRIDAY, the winner will be the team with lead at the bottom of last full inning.
- 11 Saturday and Sunday NO NEW inning after 1:20 no drop dead (strictly monitored, umpires will keep and announce official start time)
- 12 NO Time limit on the Championship or IF NEEDED games
- 13 ASA Run Rule in effect, 15 after 3, 12 after 4, 8 after 5, 1 after 7
- 14 All substitutions will come through the home plate umpire and be communicated to both dugouts.
- 15 Field ground rules will be explained at the pre-game conference.



Coaches, Player, Parent Expectations

As stated above, we the Staff of McCall Mountain Madness want to host a fun and complete summer tournament where players play hard, coach's coach strong and parents root their kids on.

Understanding that we put emphasis on the "fun" of this tournament, the Tournament Director(s) have expectation of Coaches, Players and families that must be adhered to at all times.

Tournament Directors and Umpires are committed to promoting a professional, well run Tournament.

If for any reason these expectations are unacceptable to your Team, we understand you looking for a different tournament to attend in place of ours.

Coaches-

- 1) Head Coaches have the right to communicate with umpires, but will do so in a professional, courteous and respectful manner.
- 2) All Coaches will not direct any negative communications to opposing players.
- 3) Head Coaches will communicate directly with Tournament Director(s) with any issues.

Players-

- 1) Players will leave communication with umpires to coaches.
- 2) Players will play hard, play to win, but win or lose will end the competition at the end of the game.
- 3) Players will cheer FOR their team and not AGAINST or taunt their opponents.

Parents-

- 1) Family members/friends will be content to let their kids compete and understand they are non-participating spectators of the games.
- 2) Family members/friends will root for their team and not root against their opponents.
- 3) Family members/friends will not direct any negative communications to opposing players, coaches or umpires.
- 4) Family members/friends will work through their Head Coach for any needs and not have direct communication with Tournament Directors or Umpires.

Umpires-

- 1) Will conduct themselves professionally at all times.
- 2) Will manage the game for the safety and sportsmanship of both teams.

2017

2017			
FRIDAY	Fairway A	Fairway B	MDHS
	Age - Game#	Age - Game#	Age - Game#
	1:20 no new inning	1:30 DROP DEAD	1:40 between games
11:00 AM	14u G1	12u G1	16uG1
12:40 PM	14u G2	12uG2	16uG2
2:20 PM	14u G3	12uG3	16uG3
4:00 PM	14u G4	12uG4	16uG4
5:40 PM	14u G5	16uG6	16uG5
7:20 PM	14u G6	16uG7	16uG8
9:23 sunset			
SATURDAY	Fairway A	Fairway B	MDHS
	Age - Game#	Age - Game#	Age - Game#
	1:20 no new inning	NO DROP DEAD	1:40 between games
8:00 AM	14u G7	12uG5	16uG9
9:40 AM	14u G8	12uG6	16uG10
11:20 AM	14u G9	12uG7 (CG)	16uG11
1:00 PM	14u G10	12uG8 (if needed)	16uG12
2:40 PM	14u G11	14u G12	16uG13
4:20 PM	14u G13	14u G14	16uG14
6:00 PM	14u G15	14u G16	16uG15
SUNDAY	Fairway A	Fairway B	MDHS
	Age - Game#	Age - Game#	Age - Game#
	1:20 no new inning	NO DROP DEAD	1:40 between games
8:00 AM	14u G17	14u G18	16uG16
9:40 AM	14u G19	14u G20	16uG17
11:20 AM	14u G21	14u G22	16uG18
1:00 PM	14u G23		16uG19 (CG)
2:40 PM	14u G24 (CG)		16uG20 (if needed)
4:20 PM	14u G25 (if needed)		
6:00 PM			

2017 McCall Mountain Madness - 12u
 July 21, 22, 23 2017

FA - Fairway Field A (west)
 FB- Fairway Field B (east)
 MDHS - McCall Donnelly High School Field

WINNER BRACKET

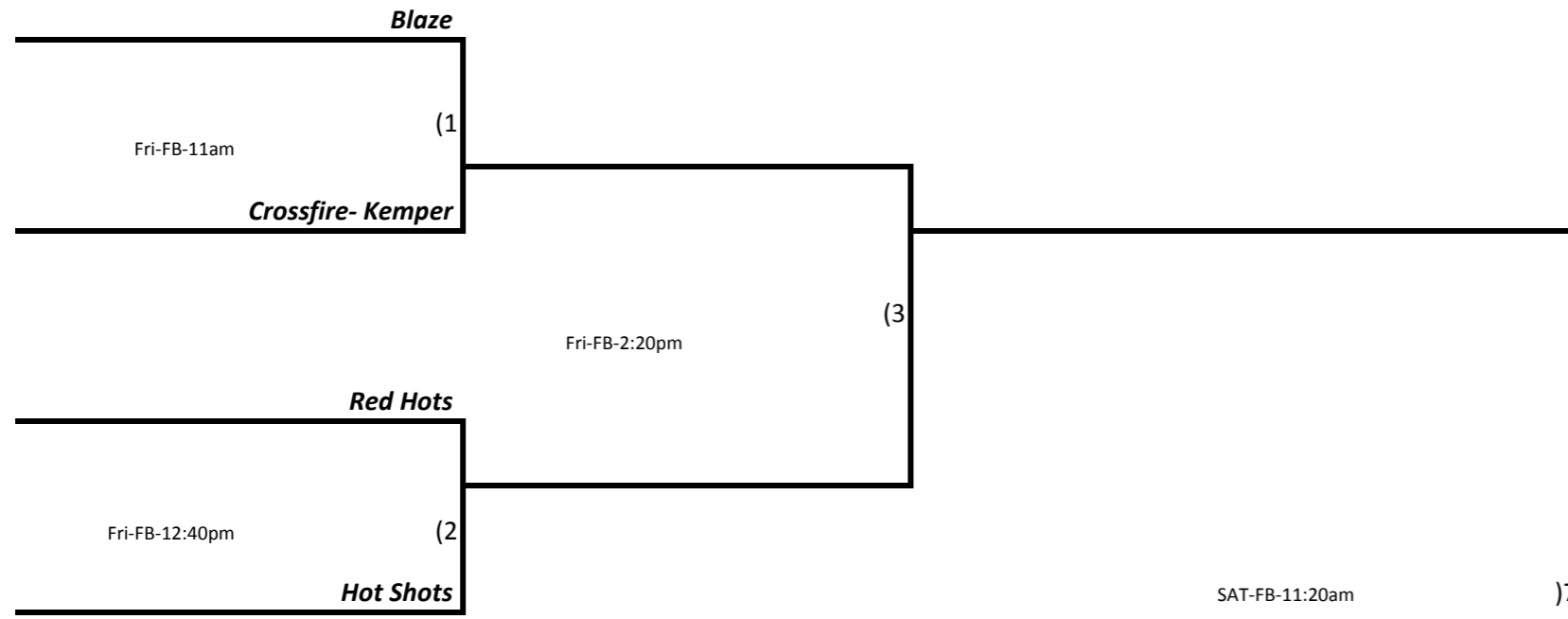

LOSER BRACKET

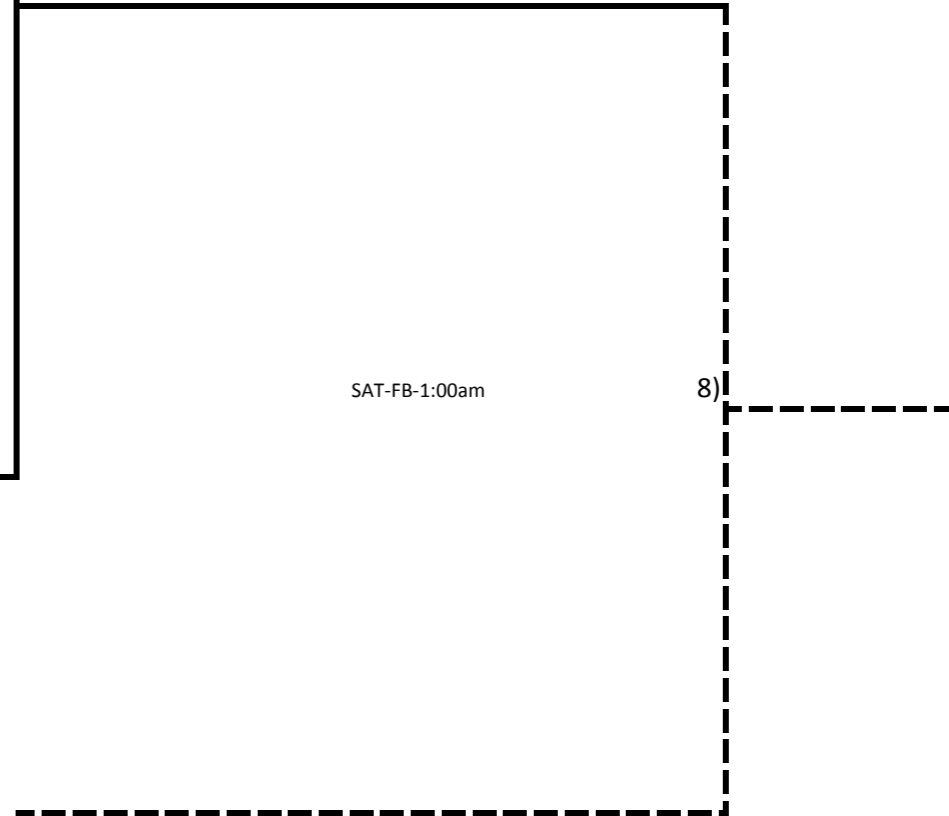
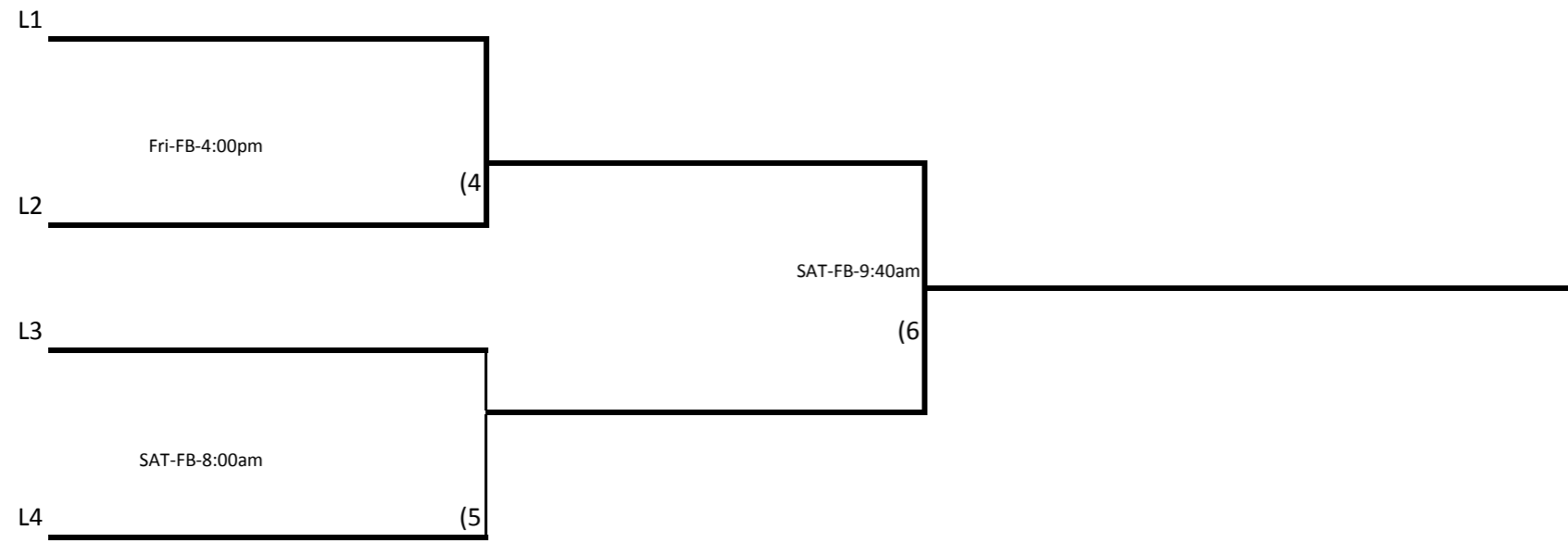

L7 If First Loss

WINNER BRACKET

2017 McCall Mountain Madness - 16u (9 Teams)
July 21, 22, 23 2017

FA - Fairway Field A (west)
FB- Fairway Field B (east)
MDHS - McCall Donnelly High School Field

Crossfire - Mendiola

FRI-MDHS-12:40pm

Boise Thunder

(2)

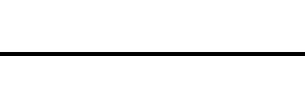

SAT-MDHS-1:00pm

(12)

Caldwell Chargers

FRI-MDHS-2:20pm

Meridian Extreme

(3)

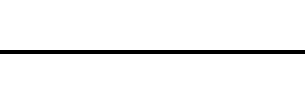

SUN-MDHS-8:00am

(16)

Racers- Zaragoza

FRI-MDHS-5:40pm

Idaho Racers -Tam

FRI-MDHS-11am

(5)

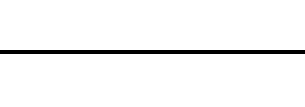

SAT-MDHS-2:40

(13)

LC Ice

FRI-MDHS-4:00pm

Idaho Gems

(4)

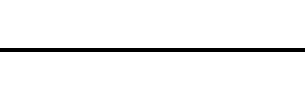

SUN-MDHS-1:00 pm

(19)

L16



LOSER BRACKET

L12

L3

FRI-FB-7:20pm

(7)

SAT-MDHS-4:20

(14)

SUN-MDHS-11:20am

(18)

SUN-MDHS-2:40 pm

(20)

L1

FRI-FB-5:40PM

L2

(6)



SAT-MDHS-9:40AM

(10)

L4

FRI-MDHS-7:20pm

(8)

SUN-MDHS-9:40am

(17)

L19 If First Loss

L5

L8

L6

SAT-MDHS-8:00am

(9)

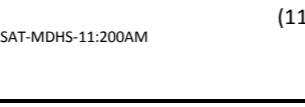

SAT-MDHS-11:200AM

(11)

SAT-MDHS-6:00 pm

(15)

L13

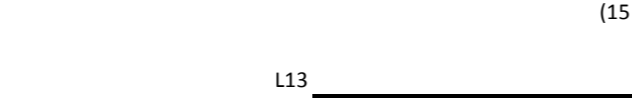

Diamond Bandits- Sullivan

(1)

L1

L3

L4

L5

L6

L7

